

Hakodate Gokoku Shrine Free Wi-Fi setting method

Free Wi-Fi configuration information

SSID : gokokujinjya
Password : 12345678

If it does not lead

- ① Please make sure there is no mistake in the SSID and password.
- ② Please connect around shrine office (radio wave will cut not reach and leave).
- ③ After the restart the smartphone and tablet, please try.

※ Wi-Fi settings for your device is not supported. Encouraging you in advance for your understanding.

● iPhone

1 Tap the "Settings"

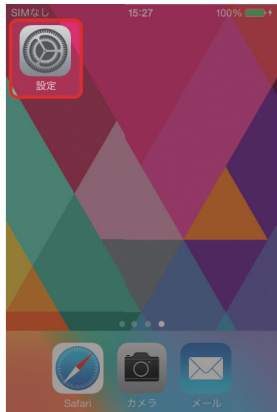

2 Tap the "Wi-Fi"



3 SSID "gokokujinjya" Find from the list



4 "12345678" after the password input, tap the "Connect"



5 Wi-Fi mark display confirmation in connection success

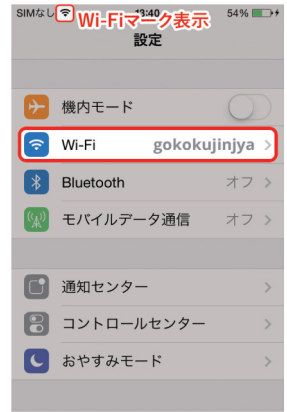

● iPad

1 Tap the "Settings"

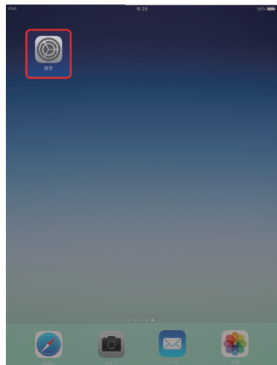

2 Tap the "Wi-Fi"

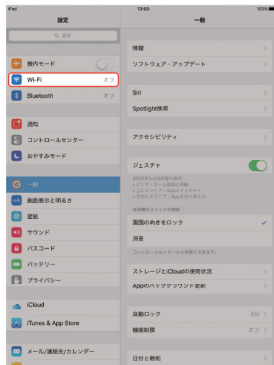

3 SSID "gokokujinjya" Find from the list

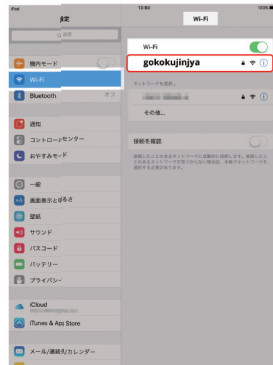

4 "12345678" after the password input, tap the "Connect"

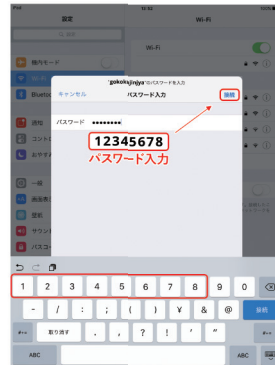

5 Wi-Fi mark display confirmation in connection success



● Android

1 Tap the "Settings"

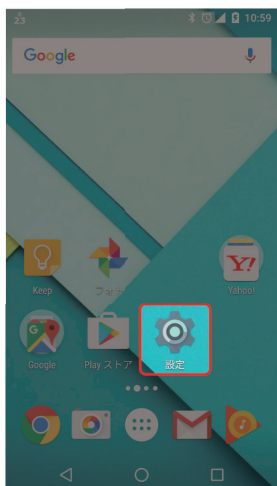

2 Tap the "Wi-Fi"

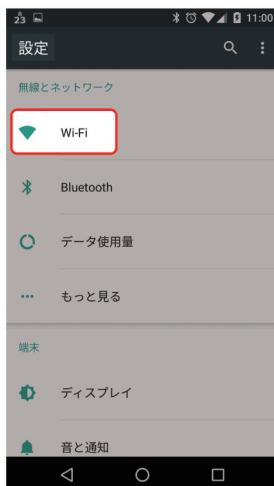

3 SSID "gokokujinjya" Find from the list



4 "12345678" after the password input, tap the "Connect"



5 Wi-Fi mark display confirmation in connection success

